

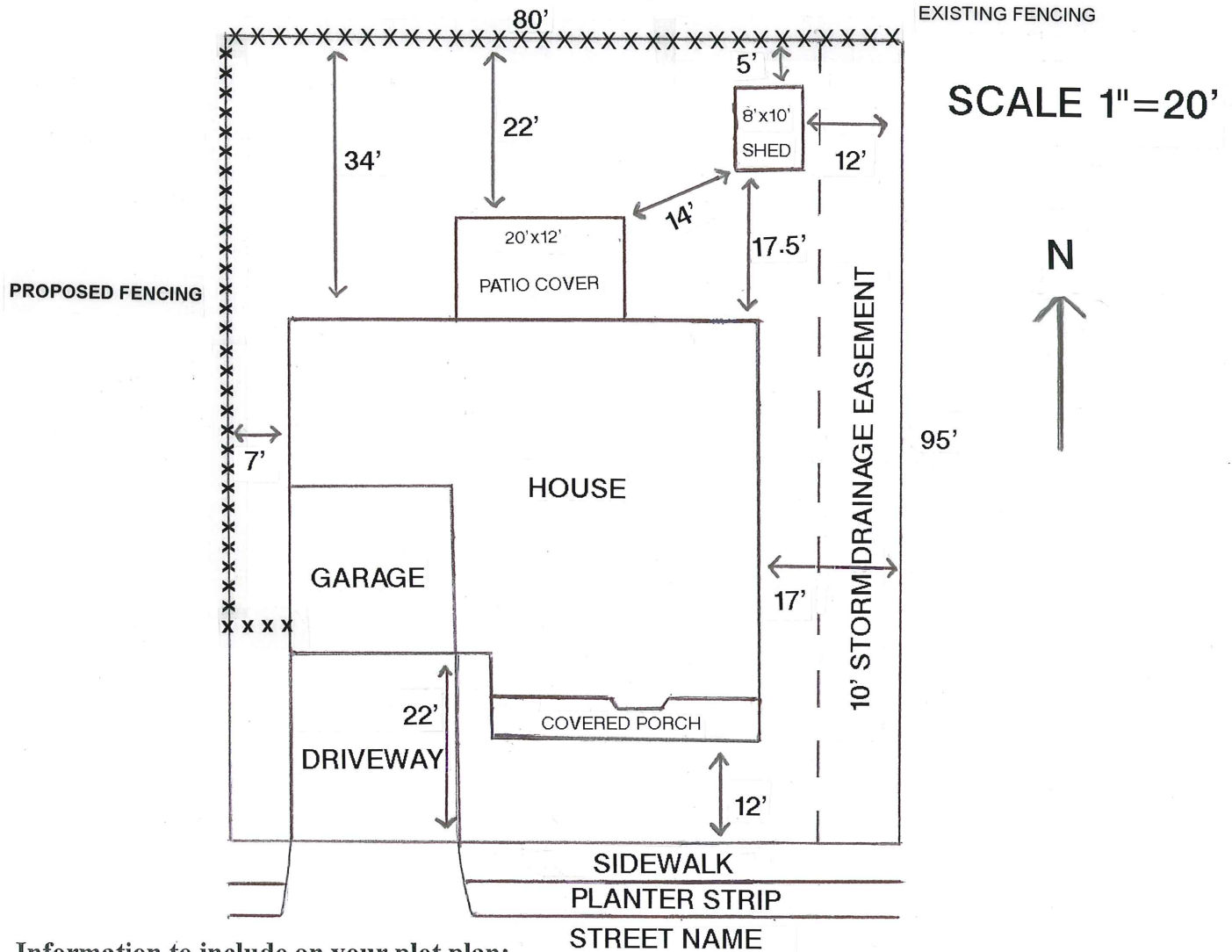

CITY OF BATTLE GROUND
 COMMUNITY DEVELOPMENT DEPARTMENT
 PLANNING: (360) 342-5047 OR BUILDING (360) 342-5046

SAMPLE RESIDENTIAL PLOT PLAN
 (BGMG 17.106)



Information to include on your plot plan:

- Draw plot plan to scale
- Property lines and dimensions
- Footprint of existing home and existing accessory buildings (if applicable)
- Current house address
- Street names abutting the property
- Locations and descriptions of easements (if applicable)
- Location of existing fencing (if applicable)
- Proposed structure; include dimensions of structure as well as setbacks to property lines and the distance to other structures on site
- Location, dimension and height of proposed fencing
- Include directional north arrow and scale key